



No. 4

Do - It - Yourself Solutions

Covering a doorway



What you will need for the job

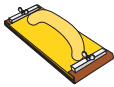
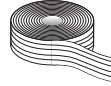

- DIY Total Joint Finish
 - DIY Trimming Knife
 - DIY Plasterboard Screws
 - DIY Plasterboard Nails (for use with timber or masonry floor)
 - DIY Paper Jointing Tape
 - DIY 150mm Broad Knife
 - DIY Hand Sander
 - DIY Dust Mask
 - DIY Sandpaper 150 Grit
- Refer to Boral Plasterboard DIY Worksheet No.6 - Jointing and finishing*

Other

- Boral Plasterboard Sheet
- Framing Timber

How to cover a doorway

Preparation

Remove existing door, door jamb and any architraves, skirting boards, mouldings, etc.

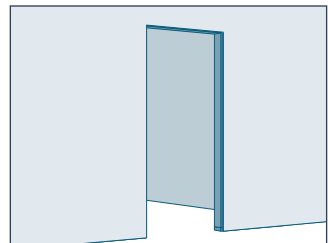

Option A - Cut back existing wall lining

- 1 Measure the width of the wall stud and framing at the head of the doorway.
- 2 Use the Trimming Knife to cut back the existing wall lining so half the width of the studs and door head framing are exposed.

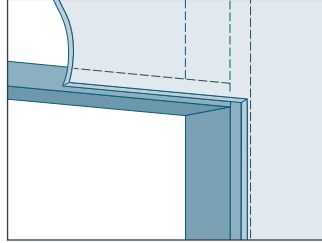

Option B (recommended) - Leave existing wall lining

- 1 Alternatively do not cut plasterboard lining back, but attach an extra door head framing member and one extra wall stud to each side of the doorway.
- 2 Make sure these extra framing members are the same width as the existing wall frame.

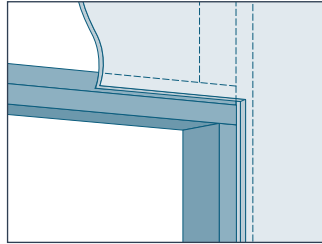

Fixing wall plate

- 1 Cut a length of wall plate (timber framing) to fit between the studs in the opening at the bottom of the doorway.
- 2 Fix this bottom wall plate to the floor (using suitable nails for timber floors or masonry nails for concrete floors).

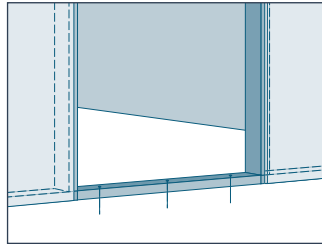

Fitting centre stud

- 1 Measure, cut and fit a wall stud in the centre of the opening between the outside studs (for openings up to 1200mm wide).
- 2 Nail the stud to the bottom plate and door head framing.

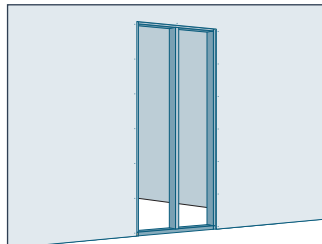

Fixing plasterboard sheets

- 1 Using the trimming knife cut plasterboard sheet to suit the size of the existing doorway cut out of the wall lining.
- 2 Fix Boral Plasterboard sheets to both sides of the framing members and centre studs, by nailing with plasterboard nails or screws at 300mm centres. Use longer nails or screws for 13mm thick Boral Plasterboard sheets.

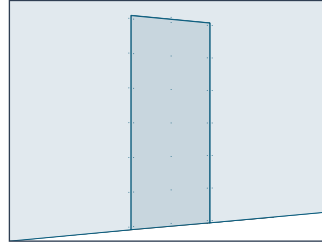

Finishing

- 1 Finish the joints with Boral Plasterboard Paper Jointing Tape and DIY Total Joint Finish. *[Refer to Boral Plasterboard DIY Worksheet No.6 – Jointing and finishing].*
- 2 Fix new skirtings to match existing skirtings on both sides of the wall.

Health & Safety

- 1 Do not ingest contents of product packaging. If ingested, seek medical advice. 
- 2 Avoid creating dust when handling, mixing or sanding as dust from packaged products may contain crystalline silica. Repeated inhalation of silica dust over long periods of time may lead to bronchitis, silicosis or cancer. If dust is unavoidable, ensure adequate ventilation, wear eye protection and an approved disposable face mask that conforms to Australian Standards AS 1716 Type P1 or P2.
- 3 If dust or paste causes skin irritation, use impervious PVC, Nitrite or Rubber gloves.
- 4 Keep contents out of reach of children. 

Contact Information

In Emergencies call 1800 033 011, Poison Information on 13 11 26.

Note: If you don't feel confident enough to take on this project, contact your local Boral Plasterboard sales outlet for a list of competent contractors in your area.

For further technical assistance or more information on Boral Plasterboard DIY products, please contact TecASSIST 1800 811 222 or your local Boral Plasterboard sales office:

QLD	07 3115 7300	SA	08 7002 6300	VIC	03 9214 2138
TAS	03 6278 9966	ACT	02 6280 4243	WA	08 6226 9825
NSW	02 9638 0571	NT	08 8984 4484		

Boral Australian Gypsum Limited
A.C.N. 004 231 976
676 Lorimer St, Port Melbourne Vic 3207
<http://www.boral.com.au>

 is a registered trademark of Boral Plasterboard.

